

ASTLEY AINSLIE HOSPITAL GREENSPACE MANAGEMENT PLAN

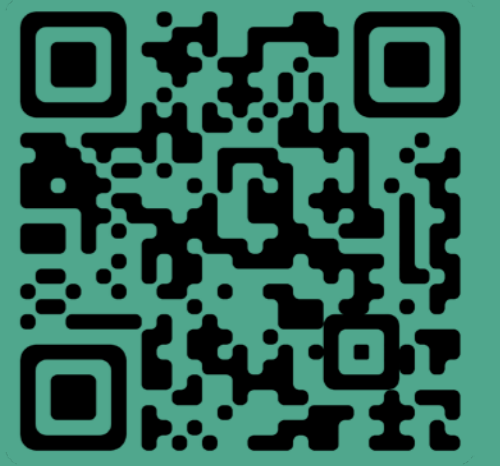

ENGAGEMENT & FEEDBACK

GROUNDS FOR HEALTH

The NHS outdoor estate is a valuable asset. If planned and managed well, it can make a significant contribution to the physical and mental health and wellbeing of staff, patients, visitors and local communities. It is also a key asset in our response to the climate emergency.

Grounds for Health works with staff and partners across a wide range of sites to unlock this potential through our Greenspace and Health programme. The aim is for the grounds to be activated, giving people a variety of reasons to use different parts of the site.

THE GREENSPACE MANAGEMENT PLAN

NHS Lothian Charity (previously known as the Edinburgh and Lothians Health Foundation) and NHS Lothian (NHSL) have appointed LTLA (landscape architect) to produce a greenspace management plan for the Astley Ainslie Hospital.

The plan aims to deliver on two outcomes:

- Enhancing the therapeutic environment of the Green Estate, and
- Meeting NHS Lothian climate change and biodiversity commitments as part of NHS Lothian's Sustainable Development Framework and the Edinburgh and Lothian Health Foundations Greenspace and Health Strategy.

OUR APPROACH

Throughout June 2022 we worked closely with stakeholders including representatives from the Astley Ainslie Community Trust, the estates management team, the Occupational Therapy staff team, and the arts and greenspace working group. We invited people to take us on a walkover of the site, pointing out features and opportunities as well as barriers to use of the greenspace as it exists.

To date we have discovered a range of greenspace enhancement opportunities. We are at a stage where we would like to widen the discussion to hear the ideas and feedback of staff, patients, visitors, and residents within the local community.

The timeframe for the plan is 5 years, with a review to be undertaken after 2 years and annual commitment to carry out the detail of the work plan, subject to commitments of funding and resources.



The Astley Ainslie Hospital is a 43-acre site, managed by NHS Lothian. It provides in-patient and out-patient rehabilitation services, and serves as administrative bases for a number of NHS Lothian teams.

- Staff teams are keen to use the outdoor greenspace resource as a setting for rehabilitative therapies, in-patient recreation, and to enjoy their breaks in the working day.
- The grounds are well used by people living in the local community; the estate offers opportunities for off-road walking and cycling routes, a parkland environment to relax and meet people, enjoyment and appreciation of nature, and a setting for an outdoor children's nursery.
- The Green Estate isn't just for people's benefit, but a highly valuable natural environment offering a variety of habitats and contributing significantly to the greenspace infrastructure.

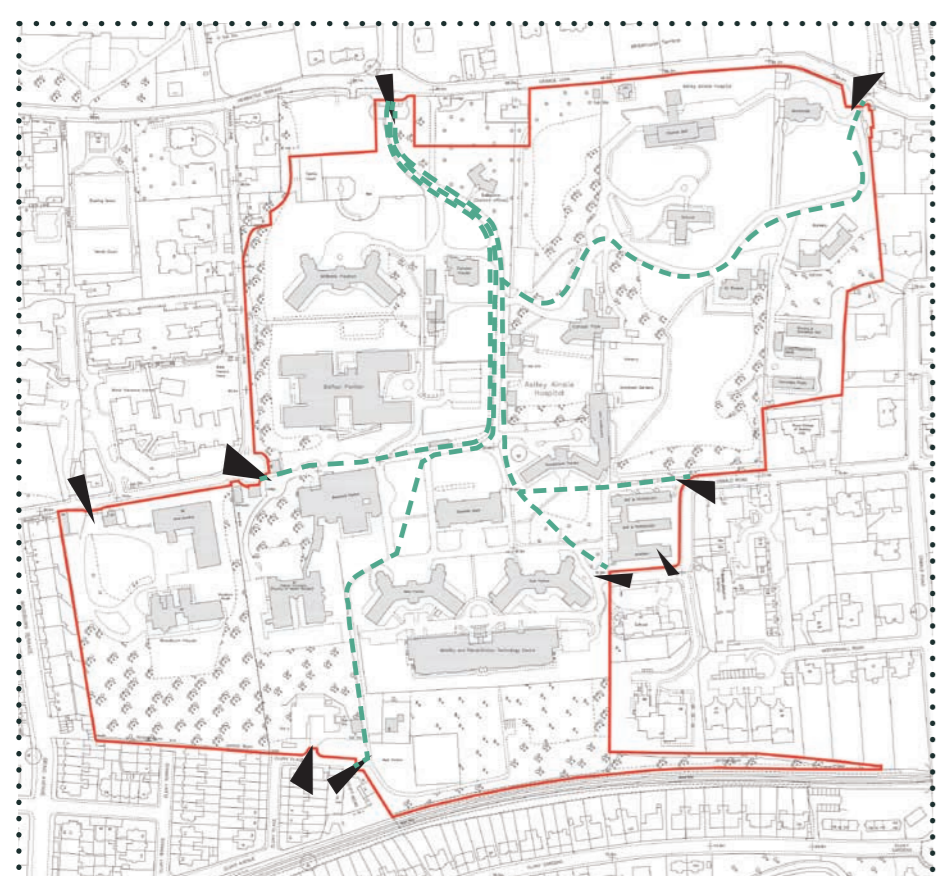

NHS Lothian green estate boundary with entrance locations and rights of way (accepted by City of Edinburgh Council and NHS Lothian, and added as Asserted to the National Catalogue of Rights of Way held by ScotWays, 2016)

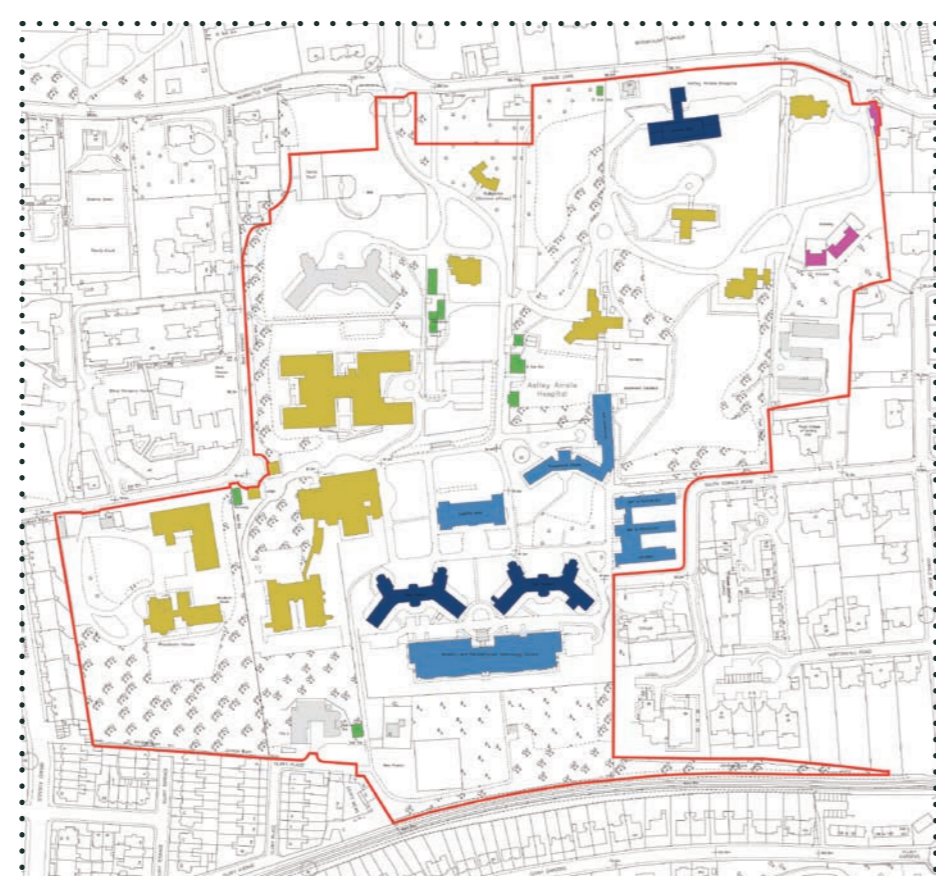

Current building functions

- In patient
- Out patient
- Office
- Facilities
- Community
- Demolished / vacant



Existing public uses of the AAH greenspace

- Footpaths / woodland trails
- Key area used for Forest School
- Picnic spots
- Cycle links / routes to school
- Running
- Foraging
- Art / sketching
- Heritage appreciation

PROPOSED PROJECTS / ACTIVITIES

Structured around the recommendations of the report 'Biodiversity and Climate Change Assessment for the NHS Lothian Estate' (Natural Capital Solutions, March 2021), a series of projects and activities which respond to greenspace enhancement and management objectives has been identified.

The Biodiversity and Climate Change Assessment was commissioned by the NHS Lothian to deliver a biodiversity, climate change and nature-based health benefits assessment of the natural capital assets (habitats) of their estate. It offers a valuable framework and working structure, establishing a baseline and allowing future transformations and implementations to be measured and reported.

The recommendations outlined by Natural Capital Solutions offer 5 themes to set out greenspace management proposals. Each theme is represented with a spatial diagram and illustrated with reference images from precedent greenspace projects on the following 5 panels.

FEEDBACK!

We know the real experts in a place are the people who use it, whether daily or just every so often. We value and welcome your feedback on these early greenspace management ideas, and are grateful for your time in sharing any responses.

Please feel free to respond to any or all of the themes. There is an online survey to collect feedback, please use the QR code above or this web link:

www.surveymonkey.co.uk/r/HPGSDVM

ACCESSIBILITY

Accessibility is important to us. These boards are typeset with Arial font in 'regular' style, with body text in black, size ranging between 16 - 20point. Please get in touch with Liz if you would like this information in a different format, or have difficulty accessing the online survey : hello@lizthomaslandscapearchitect.co.uk